

# Dry Areas in the Region

## Fact Sheet

### Where are the Dry Areas?

There are four (4) Dry Areas within the Council area, these are located to:

1. Goolwa Skate Park ([Attachment 1](#))
2. Strathalbyn Skate Park ([Attachment 2](#))
3. Strathalbyn township - ([Attachment 3](#))
4. Port Elliot township ([Attachment 4](#))

This Fact Sheet provides answers to some of the most frequently asked questions about alcohol Dry Areas.

### What is a Dry Area?

A 'dry area' is an area where the consumption of alcohol or possession of open containers of alcohol is prohibited. This applies even if you are just moving through a Dry Area.

Possession of alcohol in an open container does not take account of whether the alcohol is being consumed or not. A person can possess alcohol (e.g., a carton of beer, a bottle of wine or alcohol in an esky) in a Dry Area provided the container is unopened.

### When do the Dry Areas apply?

#### Strathalbyn township

The Dry Area operates from 9.00pm on each day to 6.00am on the following day, seven days a week. People can consume alcohol or possess open containers of alcohol in these areas at other times of the day.

#### Goolwa Skate Park

The Dry Area operates for 24 hours a day, seven days a week.

#### Port Elliot township

The Dry Area operates from 10.00pm on each day to 6.00am on the following day, seven days a week. People can consume alcohol or possess open containers of alcohol in these areas at other times of the day.

#### Strathalbyn Skate Park

The Dry Area operates for 24 hours a day, seven days a week.

### Where can I find further information about the Dry Areas?

Details of the Dry Areas in the Alexandrina Council area are provided on the Council's website [www.alexandrina.sa.gov.au/live/community/dryzones](http://www.alexandrina.sa.gov.au/live/community/dryzones)

Council has erected signs at the main entry points to each Dry Area and around the streets of the Dry Area. It is not a defence to a charge if you claim you did not see a sign or even if there is no sign present where you breach the rules of the Dry Area.

Information about Dry Areas is available from both the Goolwa and Strathalbyn Council Offices, and Council's Visitor Information Centres in Goolwa and Strathalbyn, as well as Council's website.

### **Why have Dry Areas been designated?**

The implementation of the Dry Areas should reduce the incidence of public drinking and anti-social and petty criminal behaviour by public drinkers late at night and early in the morning, with consequent increased safety for the general public.

Dry Areas will raise awareness amongst all community members that drinking to excess in public is not a socially acceptable activity. Local residents and visitors alike need to be aware that the Alexandrina Council is a proactive, socially responsible and family friendly community.

### **What penalties apply for breaching a Dry Area?**

A person who consumes alcohol or has possession of opened containers of alcohol in a Dry Area between 9.00pm and 6.00am (Strathalbyn), between 10.00pm and 6.00am (Port Elliot) or anytime within a 24-hour time period (Goolwa Skate Park) is guilty of an offence. The offence carries a maximum penalty and offenders are usually issued with an expiation notice plus payment of a Victims of Crime Levy.

### **Who monitors the Dry Areas?**

SA Police will monitor the Dry Areas. They should be contacted on all matters relating to the Dry Areas by phoning 13 14 44.

### **If I live or work within a designated Dry Zone area, can I consume alcohol or possess an open container of alcohol on my own property?**

Yes. Rules for Dry Areas only apply to public places.

### **Can permission be gained to hold an event involving alcohol in a Dry Zone area?**

A permit can be sought from the Alexandrina Council to hold an event in a public place within a Dry Area. Permission should be sought approx. three months in advance of the event. Any permit issued may specify certain conditions under which the event can occur, such as the starting time. You will also need to apply to the Office of the Liquor and Gambling Commissioner for a Limited Liquor Licence if the function is being held with the designated Dry Area times.

### **Can alcohol be consumed in a privately-owned vehicle in the Dry Zone Areas?**

A person is not permitted to consume alcohol or possess an opened container of alcohol in a privately-owned vehicle within a Dry Area.

### **Does the Dry Area affect private property?**

Rules for the Dry Areas only apply to public places, so you may consume alcohol or possess an open container on private property providing that doesn't cross the private boundary and stray into the Dry Area.

### **Are Caravan Parks affected if they are located within a Dry Area?**

Within the Alexandrina Council region, Caravan Parks have not been included within the Dry Area boundaries. However, there may be local Caravan Park rules which apply to the consumption of alcohol within the Caravan Park.

### **Can alcohol be consumed in a privately owned vehicle in a Dry Area?**

A person is not permitted to consume alcohol or possess an open container of alcohol in a privately owned vehicle within a Dry Area.

# DRY ZONE



# Map of Goolwa Skate Park Dry Area

(continuous – no expiry)

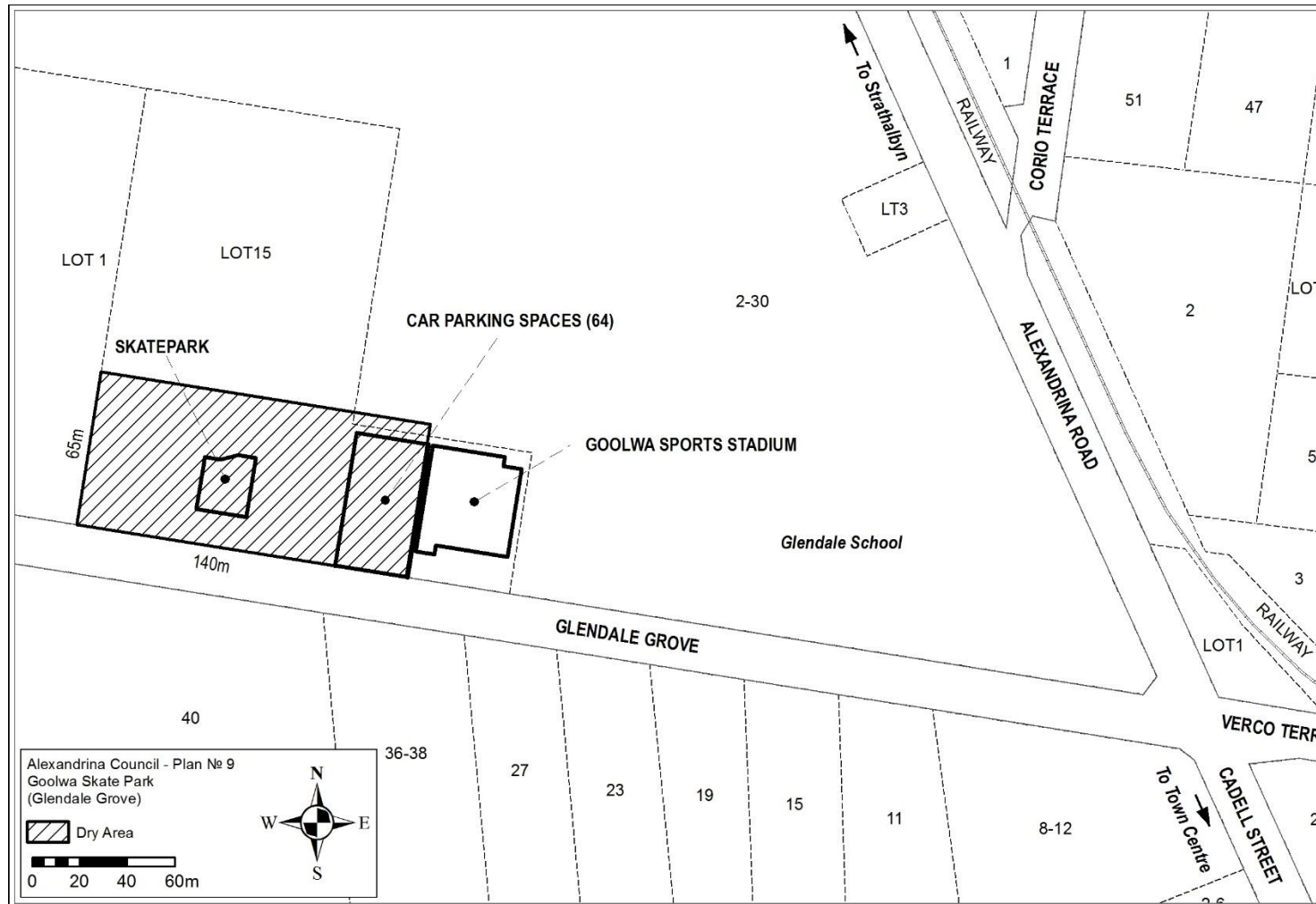

## Map of Strathalbyn Skate Park Dry Area

(continuous – no expiry)

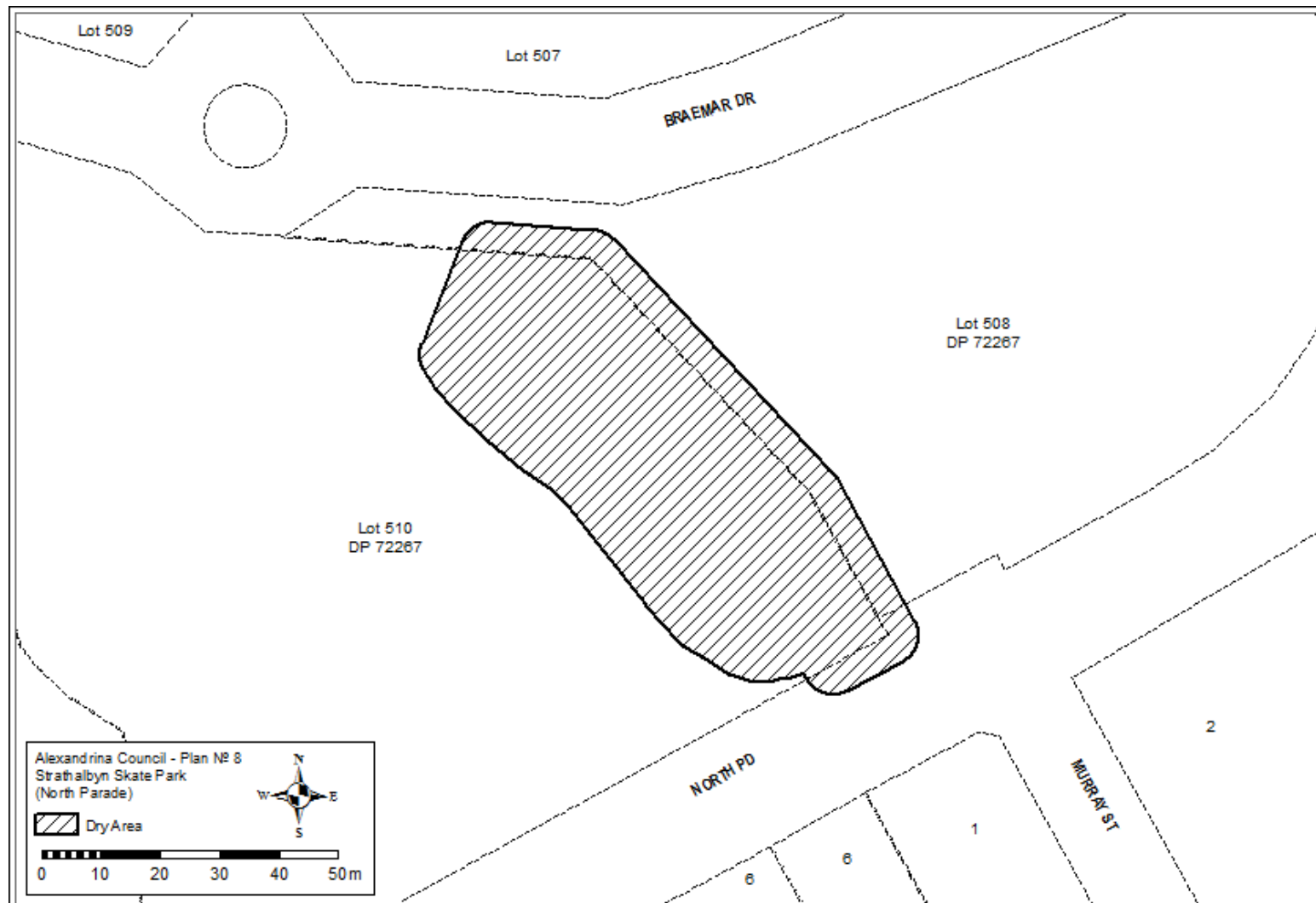



# Map of Strathalbyn Dry Area

(continuous – no expiry)

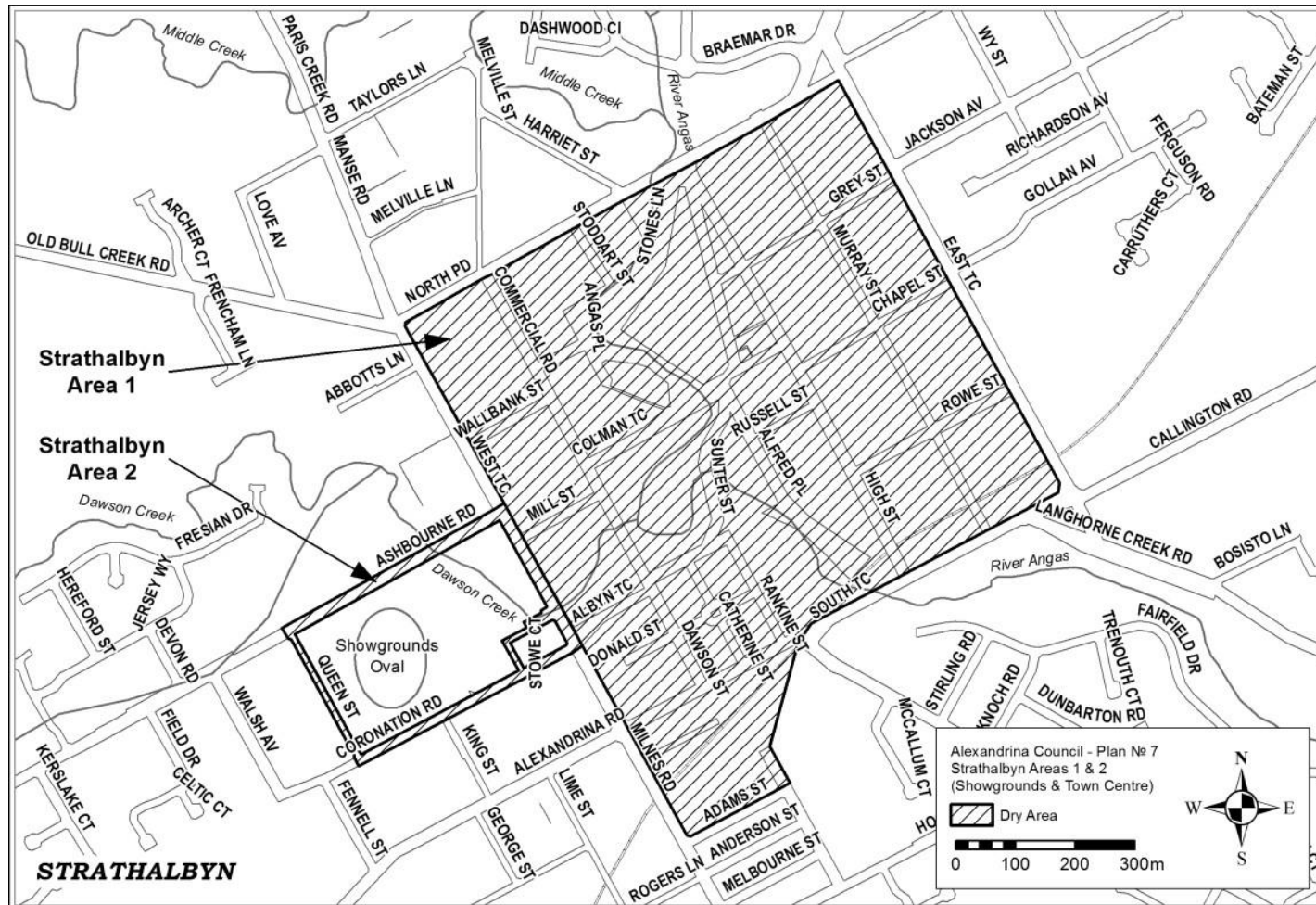

**(continuous – no expiry)**

